

“TO EVERYTHING THERE IS A SEASON, A TIME FOR EVERY PURPOSE UNDER THE HEAVEN...”

- Ecclesiastes 3:1



CHABAD OF HAWAII  
CHAI CENTER FOR JEWISH LIFE

*Building Campaign*



*“...a time to be born...”*

## CHABAD OF HAWAII

*I*n the middle of the largest ocean on Earth, on an island with the world’s most remote population center, Yiddishkeit is thriving. Here you will find a dynamic Jewish community, school, daily minyan, warm Shabbat gatherings, stimulating adult education and, yes, plenty of aloha.

Nearly 20 years ago, the Lubavitcher Rebbe, Rabbi Menachem M. Schneerson, ob”m, gave his blessing to open a branch of Chabad in Hawaii, to spread the light of Judaism to one of the farthest corners of the Earth. So in August of 1987, with a toddler and infant in tow, Rabbi Itchel & Pearl Krasnjansky set out to turn Hawaii into a blossoming center for Jewish life.

Fortified with a blessing from the Rebbe and their irrepressible youthful idealism, the Krasnjanskys began: meeting Jews anywhere and anyhow they could and inviting them to their home for davening (prayer service) and homemade Shabbat meals. Soon there were holiday programs that attracted scores of kama’aina and tourists. Yiddishkeit had its first address in Hawaii: “CHAI” - Chabad of the Islands. And it grew.



## A DREAM BECOMES REALITY

*T*oday, twenty years later, Chabad of Hawaii is home to a vibrant and growing Jewish community. Chabad still hosts weekly Shabbat dinners and Shabbat kiddush lunches, but no longer do the Krasnjanskys have to clear their own living room. There are ever-expanding social events, classes, and programs. There are activities on the Neighbor Islands, and a rich website and newsletter.

Chabad has welcomed all, regardless of education or affiliation, motivated only by our philosophy to love every Jew, educate every Jew, and reach out to help every Jew. By honoring that commitment since 1987, Chabad has become the focus of Jewish life in Hawaii for the local community and for thousands of out-of-town visitors, touching the lives of so many.

Now, Chabad of Hawaii is calling on you to help us grow.

The time has come to take the next step, to build a Center for Jewish Life that will expand its reach to touch, educate and inspire all who walk through its doors, visitors and kama'aina alike. A Center that will educate generations to come in the joys of Judaism. We invite you to become an active partner in this exciting project. To play a vital role in ensuring the future of our people. To invest in a vital enterprise that educates, inspires and builds Jewish pride.

## FROM THE CAMPAIGN COMMITTEE CHAIR

*Dear Friends,*

Almost twenty years ago, Chabad of Hawaii opened its doors in the Hawaiian Islands. Rabbi Itchel & Pearl began to establish a center for Jewish life, reaching out to Jews on all Islands with Shabbat & holiday programs, children's events, Torah classes and a host of other activities. Few Jewish residents or visitors have not been touched by this remarkable outpouring of love and energy.

Now the time has come for us to reach out, to help build a permanent Center that will house a shul, classrooms and a beautiful mikvah. The Center will be an incredible asset to our community, ensuring the education of our children and the perpetuation of our people.

It is up to us to turn this dream into a reality. I'm sure we can count on your support.

*Dr. Joyce Cassen,*  
Campaign Committee Chair

*"...a time to build..."*

## BUILDING COMMITTEE

THE HONORABLE LINDA LINGLE, HONORARY CHAIR

DR. JOYCE CASSEN, CHAIR

LAURENCE BALTER

BORUCH DUCHMAN

BENNETT HYMER

RABBI ITCHEL KRASNJANSKY

PEARL KRASNJANSKY

GIL NEGRIN

PINCHAS NEUMAN

STUART PLATT

RANDALL PREISER

REB ITCHE

KEVIN RICHTER



*“...a time to love...”*

## CHABAD-LUBAVITCH WORLDWIDE

Chabad-Lubavitch is a pioneering force that has changed the face of world Jewry. Since its founding over 200 years ago, Chabad has brought the experience of living Judaism to millions, affecting Jewish life in almost every corner of the globe.

Under the leadership and guidance of the Lubavitcher Rebbe, Rabbi Menachem Mendel Schneerson ob”m, Chabad-Lubavitch shlichim (emissaries) around the world direct more than 3,600 institutions dedicated to the welfare of the Jewish people. Every facet of Jewish life is addressed by these burgeoning community centers. More often than not, these Chabad-Lubavitch Centers are the only address for Yiddishkeit in their respective regions of the world.

The impact of this powerful force is felt in the global resurgence of Jewish identity and pride. From Shanghai to Hawaii, from Alaska to Zaire, the shlichim continue to realize the Rebbe’s vision; to bring the joy and celebration of Judaism to each and every Jew and thereby to the entire world.



“...a time to plant...”

## CENTER FOR JEWISH LIFE

Over the past two decades, we've heard the cries of Jewish souls in Hawaii yearning to be nourished. And we've responded. From bris to chuppah to chevra kaddisha, Chabad has been here in times of joy and celebration; in times of mourning and need. Chabad's varied programs have kindled the flames of Yiddishkeit in the hearts of all whom we've touched—CEO's and prison inmates, the affiliated and the afflicted. We've provided education, counseling, and support for youth and families, as well as the less fortunate.

Our mission is nothing less than ensuring the ultimate fulfillment of creation, man's personal destiny, and the destiny of the world. *One Jew at a time.*



*“...a time to embrace...”*

## MIKVAH

*W*hy did our great-grandmothers break through the ice of frozen rivers in Europe to use the mikvah? Why did the Jews at Masada, besieged by the Romans and with precious few supplies, nonetheless build and maintain two mikvahs?

In fact, mikvah is the secret of Jewish survival: the Jewish family—in fact the Jewish people as a whole—owe their stunning success and remarkable longevity in large part to this most vital mitzvah. Jews are a holy people because life is holy to us. Mikvah represents the ultimate celebration of life and the power—given by G-d exclusively to women—to create life.

By total immersion in the spiritually cleansing waters of mikvah, a woman nurtures and renews intimacy in her marriage. With mikvah use, we invite G-d into our marriages, our homes and our lives. Mikvah bestows blessing on our loved ones and brings sanctity to the most

intimate dimension of family life. On a practical level, many couples who observe the mikvah laws say that it helps keep their marriages fresh and exciting.

*O*ver the past two decades, Chabad of Hawaii has assisted hundreds of couples to fulfill the mitzvah (commandment) of mikvah. Our unique climate and location have enabled us to use our lovely ocean for this mitzvah, but the construction of a secure, indoor mikvah, with its inherent privacy and amenities, has been long overdue.

As the cornerstone of Jewish life, the beautiful new mikvah at the Ala Moana Hotel, built in compliance with the highest halakhic and aesthetic standards, will offer the opportunity for a deeply moving spiritual experience: a spa for the body as well as the soul, a true celebration of Jewish femininity.







“AND A RIVER FLOWED FROM EDEN TO WATER THE GARDEN...” -Genesis 2:10



*“...a time to gather stones...”*

“AND THEY SHALL MAKE ME A SANCTUARY SO THAT I MAY DWELL IN THEIR MIDST.” -Exodus 25:8



## SYNAGOGUE

For centuries, the synagogue has been the nerve center of Jewish life: a spiritual haven, away from the everyday world of distraction, a place where Jews gather joyously in prayer, immerse in learning, and celebrate simchas throughout the year.

With the building of the synagogue, Hawaii will finally have a permanent home imbued with Jewish spirit: a place where children can learn ancient melodies; a place of celebration for weddings, or of parent's pride at a Bar or Bat Mitzvah; a place of comfort for the mourner saying kaddish; a place of wonder for souls grasping the riches of our heritage. Our synagogue will ensure the future of Jewish traditions in Hawaii for the next generation... and for eternity.



## SHABBAT AND HOLIDAYS

*Warm* Shabbat gatherings, intense High Holiday services, delicious communal meals under balmy Sukkot skies, raucous dancing on Simchat Torah, awe-inspiring public menorah lightings, joyous Purim festivities, moving and relevant communal Seders: these traditions make up the fabric of our lives and imbue our days with meaning, sanctity and history. As a way of life, they are irreplaceable in implanting Jewish identity deep within our psyche.

Chabad has made these essential celebrations happen for countless numbers throughout the years. Our new Center for Jewish Life will make it possible to touch more souls with the inherent, transcendent beauty of holidays observed with joy and warmth.

*“...a time to seek...”*



## ADULT EDUCATION

Perhaps nothing distinguishes our people so much as our emphasis on lifelong learning. From our first aleph-beit to the deepest mysteries of Kabbalah, the journey of learning excites the intellect and kindles the soul.

Chabad's adult education program offers an intellectually and spiritually stimulating environment with classes in Torah, Hebrew language, prayer, Chassidism, Jewish ethics, mysticism, and more. Our halls have become a hub of Jewish learning, open to all, quenching the thirst for Torah. Our visiting bochurim (rabbinical students) are always available to study one-on-one or in groups.

The new Center will have a comprehensive library of Jewish texts, as well as an array of audio and visual materials. Above all, the new facility will provide a comfortable environment, inviting all adults to discover the vast spiritual riches of our history and people.



“...a time to dance...”

## SCHOOL

To awaken a child's heart and mind to the beauty of Judaism, to see a little one's eyes light up as Torah stories come to life, to feel the electricity in the air as they reenact Biblical tales—*this is our privileged mission*. Through our pre-school, day school, and famed Daniel Levey Chabad Hebrew School, we fill young souls with Jewish knowledge and identity. By means of plays and songs; challah, matzah and hamantashen baking; mock Seders and charming Chanukah performances; through these and so many other experiences, Hawaii's Jewish children develop an unshakeable sense of pride and destiny that will last a lifetime.

As our precious school grows, families can count on us to give each of their children the individual attention they deserve, to help them mature into educated Jewish adults. The new Center will ensure that our vital mission continues by providing dedicated classrooms, new equipment and teaching materials. After 20 years of teaching, learning, and growing, our school will finally have a permanent home

“EDUCATE THE CHILD ACCORDING TO HIS WAY, SO THAT EVEN WHEN HE WILL BE OLD HE WILL NOT DEPART FROM IT.” -Proverbs 22:6



*“...and a time to speak.”*

## GIVING

With a sense of joy and accomplishment, it is our honor, duty, and privilege to turn a building into a house of G-d, a home for every Jew. Join Chabad of Hawaii in the creation of our beautiful new Center for Jewish Life, a celebration of the past, present, and boundless future.

To recognize the contributions of our many friends and supporters, a number of dedication opportunities are available, from memorial plaques to the dedication of the entire Center. It is an incomparable way to honor a loved one or to memorialize their life. All dedications will be honored on a distinctive Tribute Wall at the main entrance of the Center. We encourage you to contact us with your specific request or to discuss how you would like to show your support.

## PLANNED GIVING

Chabad of Hawaii, through the assistance of professionals, has recently initiated its Planned Giving program. Its main instrument, the Chabad of Hawaii Charitable Gift Annuity (CGA), combines a gift with an investment. Under the gift annuity agreement, Chabad of Hawaii makes fixed rate, lifetime payments to the giver. For individuals under age 65, there is also a Chabad of Hawaii Deferred Gift Annuity (DGA).

The DGA is a good way to benefit one or two individuals and can be established for a modest sum. Establishing a CGA will generate a charitable income tax deduction, while offering a generous annuity rate. Best of all, these annuities provide substantial support for Chabad of Hawaii after the last payment has been made to the annuitants.



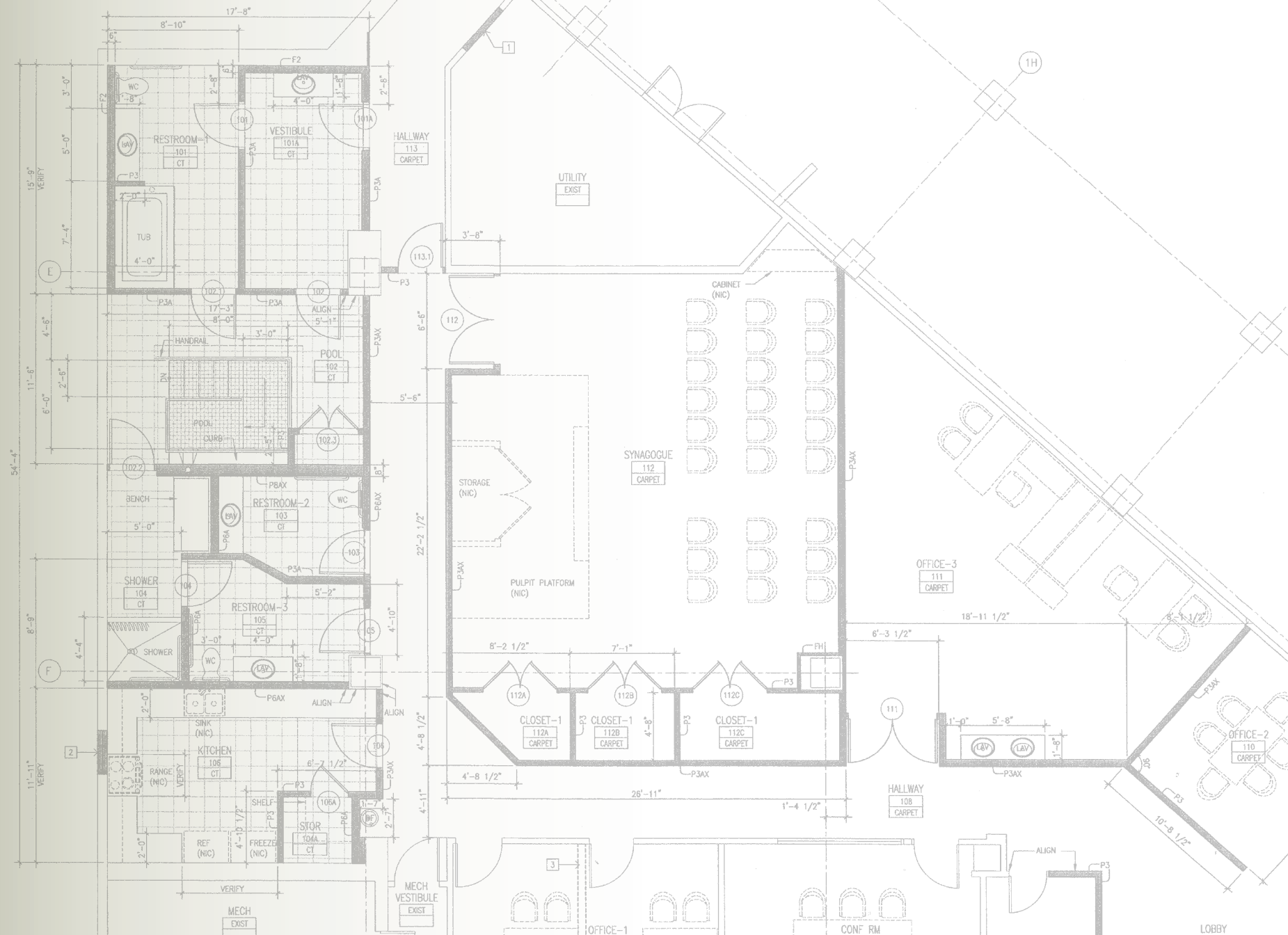









## DEDICATION AND MEMORIAL OPPORTUNITIES



|                                     |                                   |             |  |                          |  |         |
|-------------------------------------|-----------------------------------|-------------|--|--------------------------|--|---------|
| <input checked="" type="checkbox"/> | CHABAD HOUSE DEDICATION           | \$1,800,000 |  | <input type="checkbox"/> | MEZUZAH FOR MIKVAH ENTRANCE                    | 10,000  |
| <input type="checkbox"/>            | CENTER FOR JEWISH LIFE            | 1,000,000   |  | <input type="checkbox"/> | BIMAH  | 10,000  |
| <input type="checkbox"/>            | SYNAGOGUE DEDICATION              | 360,000     |  | <input type="checkbox"/> | BOOKCASE (4 AVAILABLE)                         | @ 7,200 |
| <input type="checkbox"/>            | MIKVAH DEDICATION                 | 250,000     |  | <input type="checkbox"/> | SYNAGOGUE OFFICE                               | 7,200   |
| <input checked="" type="checkbox"/> | DANIEL LEVEY CHABAD HEBREW SCHOOL | 180,000     |  | <input type="checkbox"/> | CHAZAN (CANTOR) PODIUM                         | 5,400   |
| <input checked="" type="checkbox"/> | FRONT LOBBY                       | 100,000     |  | <input type="checkbox"/> | RABBI'S PODIUM                                 | 5,400   |
| <input type="checkbox"/>            | CHABAD CHEDER PRESCHOOL           | 100,000     |  | <input type="checkbox"/> | NER TAMID (ETERNAL LAMP)                       | 5,400   |
| <input type="checkbox"/>            | SOCIAL HALL                       | 100,000     |  | <input type="checkbox"/> | TALLIT RACK                                    | 3,600   |
| <input type="checkbox"/>            | ADULT EDUCATION PROGRAMMING       | 100,000     |  | <input type="checkbox"/> | WASH BASIN (2)                                 | 3,600   |
| <input type="checkbox"/>            | JUDAICA LIBRARY                   | 100,000     |  | <input type="checkbox"/> | SEATS (150 AVAILABLE)                          | @ 1,000 |
| <input type="checkbox"/>            | COMMERCIAL KITCHEN                | 100,000     |  | <input type="checkbox"/> | MEZUZAHS (15 AVAILABLE)                        | @ 1,000 |
| <input type="checkbox"/>            | MIKVAH WELL/POOL                  | 54,000      |  | <input type="checkbox"/> | MEMORIAL PLAQUE                                | 770     |
| <input type="checkbox"/>            | ARON HAKODESH/PAROCHET            | 36,000      |  |                          |  |         |
| <input type="checkbox"/>            | YAHRTZEIT (MEMORIAL) WALL         | 36,000      |  |                          | GENERAL DEDICATION<br>OPPORTUNITIES            |         |
| <input type="checkbox"/>            | CLASSROOMS (5 AVAILABLE)          | @ 36,000    |  | <input type="checkbox"/> | FOUNDER  | 18,000  |
| <input type="checkbox"/>            | MIKVAH LOBBY                      | 18,000      |  | <input type="checkbox"/> | BUILDER  | 10,000  |
| <input type="checkbox"/>            | MIKVAH PREPARATION ROOM           | 18,000      |  | <input type="checkbox"/> | BENEFACTOR                                     | 7,200   |
| <input checked="" type="checkbox"/> | RABBI'S STUDY/OFFICE              | 18,000      |  | <input type="checkbox"/> | PLATINUM CHAI SPONSOR                          | 5,400   |
| <input type="checkbox"/>            | JUDAICA SHOP                      | 18,000      |  | <input type="checkbox"/> | GOLD CHAI SPONSOR                              | 3,600   |
| <input type="checkbox"/>            | MECHITZAH                         | 18,000      |  | <input type="checkbox"/> | SILVER CHAI SPONSOR                            | 1,800   |
| <input type="checkbox"/>            | FRONT MEZUZAH                     | 10,000      |  | <input type="checkbox"/> | <i>I WISH TO PAY MY PLEDGE OVER 36 MONTHS.</i> |         |



CHABAD OF HAWAII  
CENTER FOR JEWISH LIFE

410 ATKINSON DRIVE HONOLULU HI 96814

808.735.8161

CHABADHAWAII@AOL.COM  
WWW.CHABADOFHAWAII.COM